

NOTE: THIS PLAN IS FOR ILLUSTRATION ONLY AND IS SUBJECT TO CHANGE

HAWKSEYE

LEWES AND REHOBOTH HUNDRED
SUSSEX COUNTY, DELAWARE

-A PRIVATE COMMUNITY-
(ON THE EDGE OF A NATURAL PRESERVE)

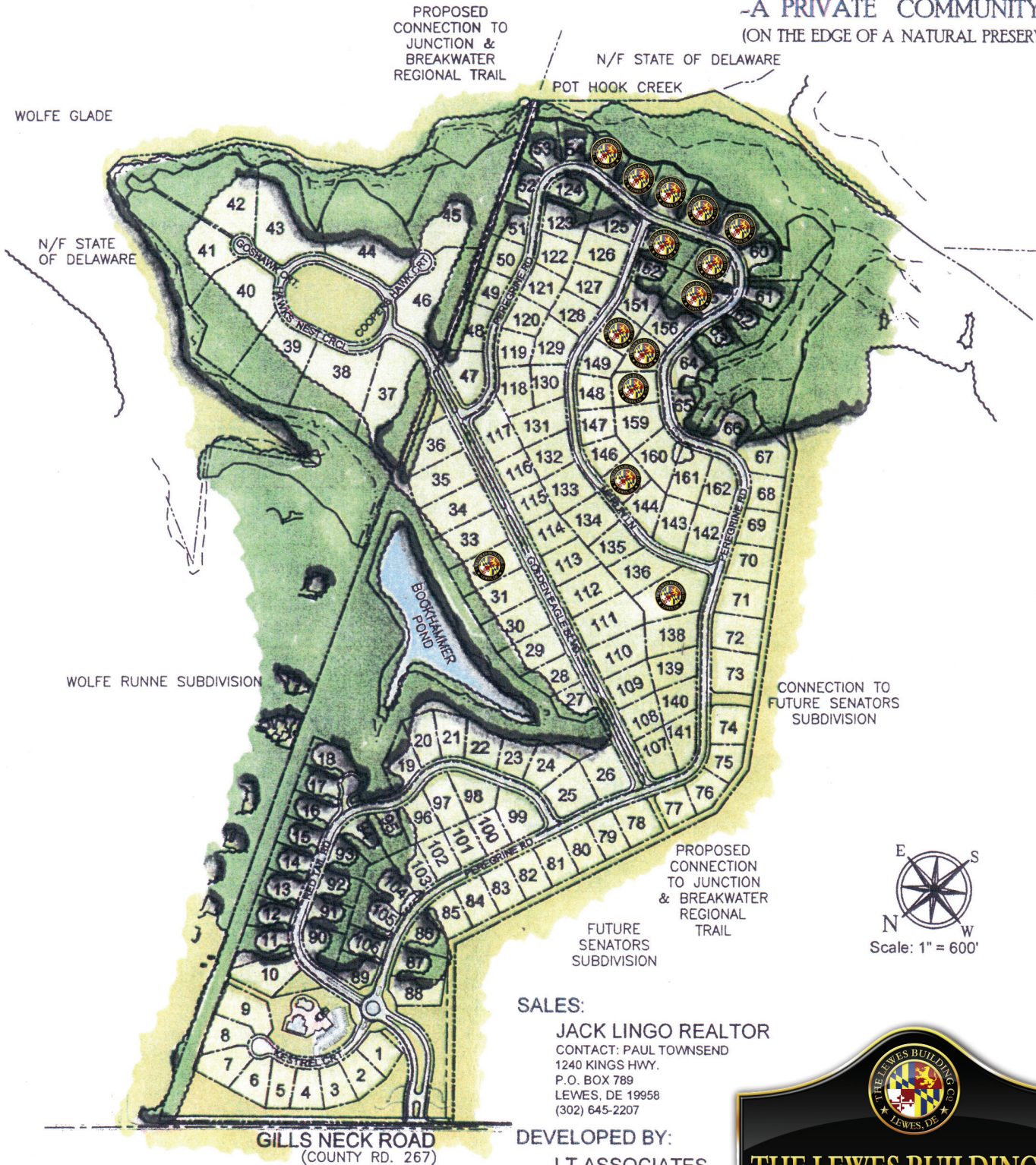

SALES:

JACK LINGO REALTOR
CONTACT: PAUL TOWNSEND
1240 KINGS HWY.
P.O. BOX 789
LEWES, DE 19958
(302) 645-2207

DEVELOPED BY:

LT ASSOCIATES



The TLBC logos represent one of our completed homes or an available lot/home package

The Delaware Beaches' Exclusive **Southern Living** Custom Builder Program Member